



V

# Chantel

collection

20  
24

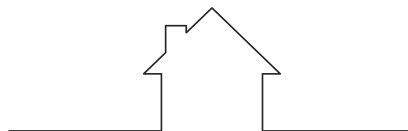

## House Collection

Chantel 1200 Single

Chantel 1500 Double

Rubie 460

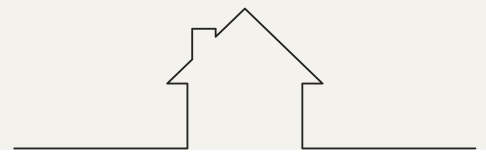

## House Collection



Chantel 1500 Double



Chantel 1200 Single



Rubie 460

## Cabinet Finish

Choose your paint finish | Custom Paint also available upon request

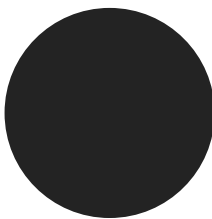

Black

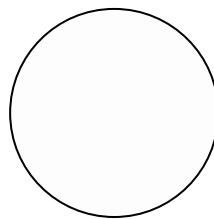

White

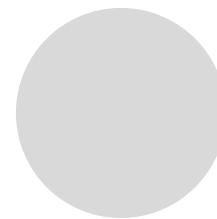

Hampton Grey

## Bench Top

Subject to availability and chosen design

## Handles

Choose a finish



**Italian Carrara**  
Natural Marble



**Snow-Blanc**  
Crystalline Silica-Free  
(Engineered Stone)

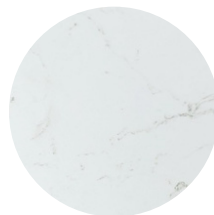

**Ayla**  
Crystalline Silica-Free  
(Engineered Stone)



Brushed Gold



Chrome



# Chantel collection

– a tribute to 1940's glamour and timeless femininity. With a nod to Old Hollywood, each piece showcases craftsmanship and true elegance. This collection embodies a perfect blend of glamour, eclecticism, and a touch of Old Hollywood charm. Elevate your space with Chantel – where style meets nostalgia in an enchanting dance of sophistication.

---

### **Chantel 1200 | Single Basin**

1200 Length x 563 Depth x 880 Height

### **Chantel 1500 | Double Basin**

1530 Length x 563 Depth x 880 Height

---

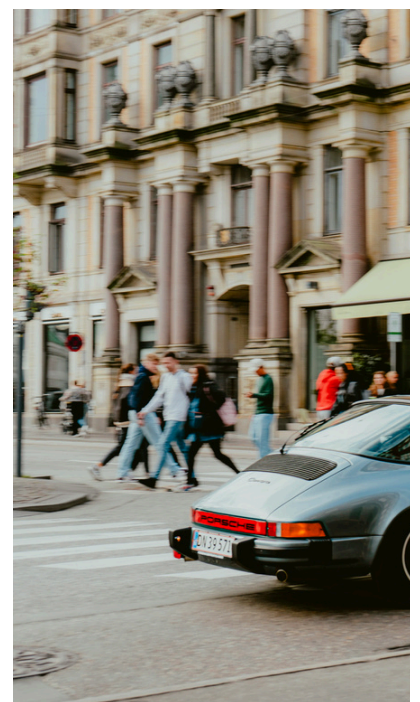
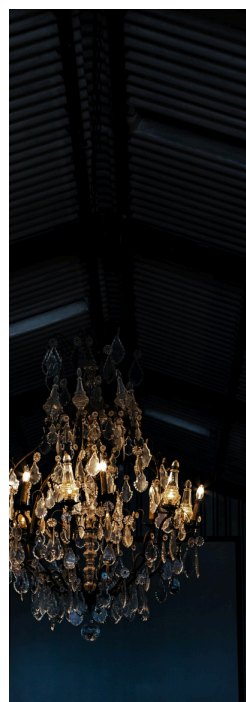

# Chantel

## Chantel 1200 Single - 2024

Cabinet Size: 1180mm (L) X 550mm (D) X 860mm (H)

Top Size: 1200mm (L) X 563mm (D) X 20mm (H)

Type: Freestanding

Basin: Oval Under-mount Ceramic Basin

Splash-back: Optional

Tap Hole: Client to nominate

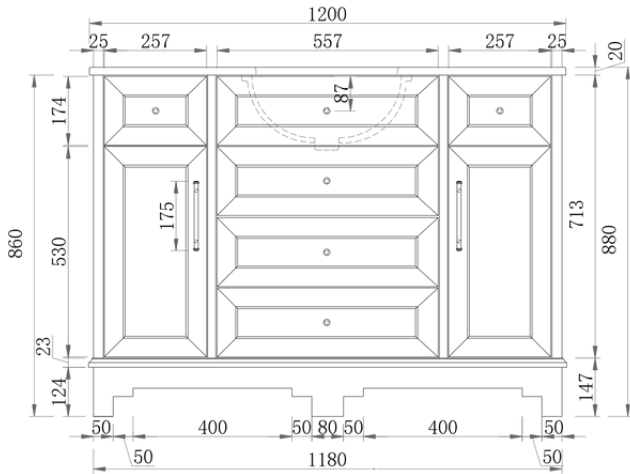
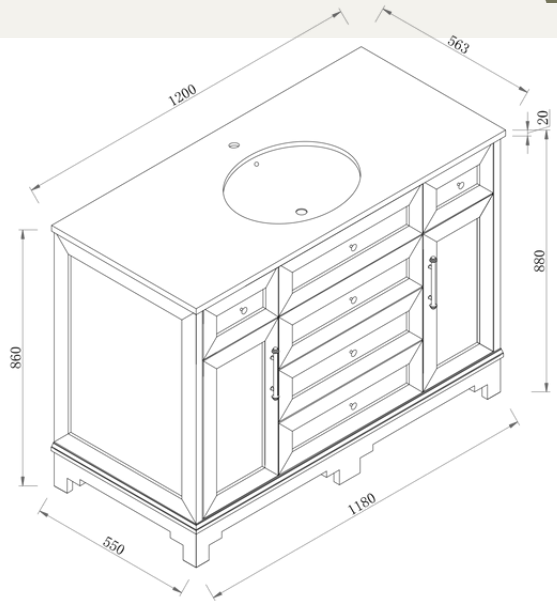

Front Elevation

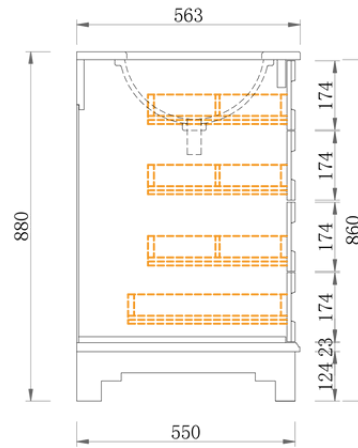

Section Side

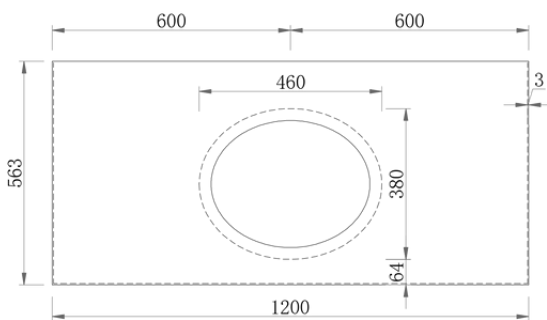

Top View

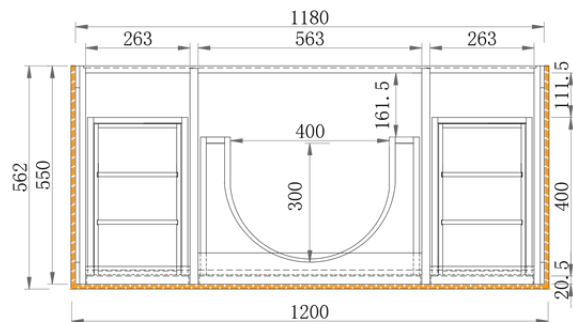

Section Top - Drawer Inserts

**Notes:**

- Wastes and faucets are not included.
- Vanity unit must be installed by a qualified tradesmen - Failure to do so will void the warranty.
- Plumbing fixtures must be installed by a qualified plumber - Failure to do so will void the warranty.
- Warranty information: 5 years on cabinet & 12 months on top and basin(s).
- Caution boxes may be heavy and will require 2 people to lift.



# Chantel

## Chantel 1500 Double - 2024

Cabinet Size: 1510mm (L) X 550mm (D) X 860mm (H)  
 Top Size: 1530mm (L) X 563mm (D) X 20mm (H)  
 Type: Freestanding  
 Basin: Oval Under-mount Ceramic Basins  
 Splash-back: Optional

Tap Hole: Client to nominate

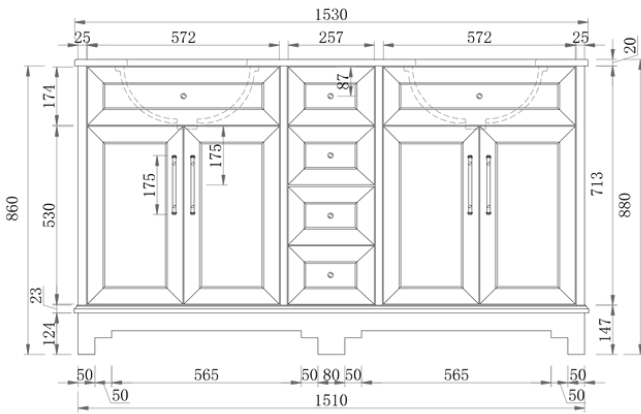
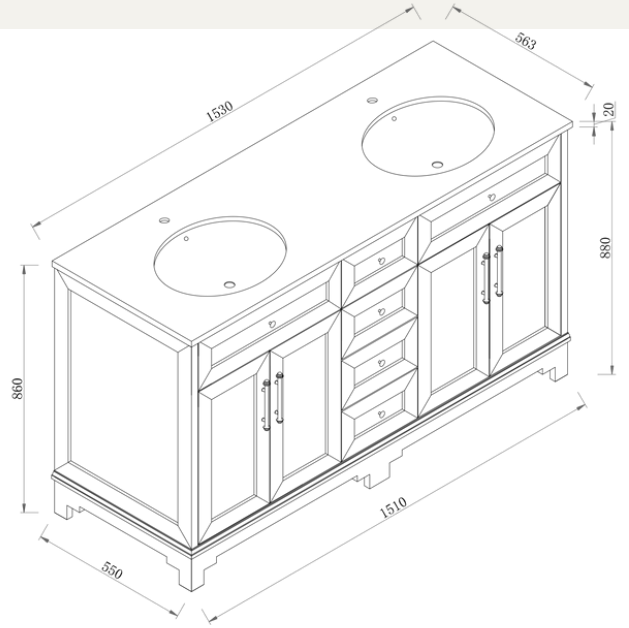

Front Elevation

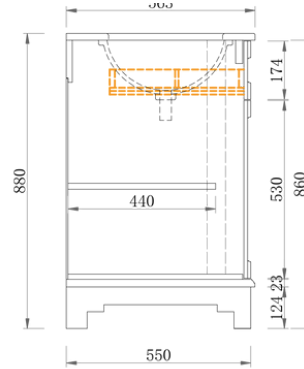

Section Side

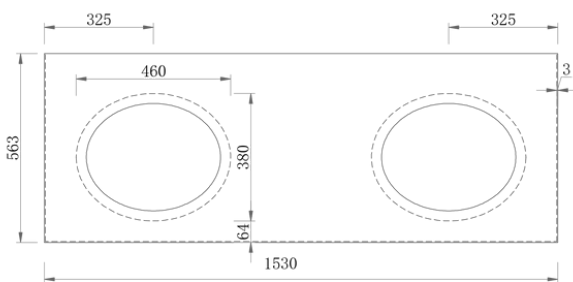

Top View

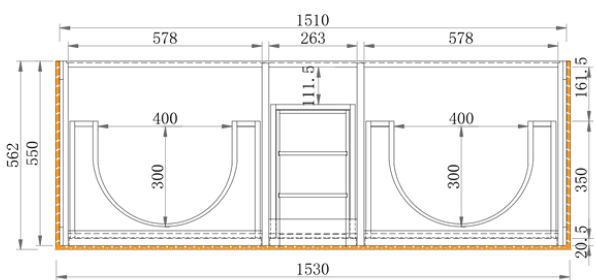

Section Top - Drawer Inserts

**Notes:**

- Wastes and faucets are not included.
- Vanity unit must be installed by a qualified tradesmen - Failure to do so will void the warranty.
- Plumbing fixtures must be installed by a qualified plumber - Failure to do so will void the warranty.
- Warranty information: 5 years on cabinet & 12 months on top and basin(s).
- Caution boxes may be heavy and will require 2 people to lift.





# Rubie

## Rubie 460

Overall Size: 460mm (L) X 255mm (D) X 600mm (H)

Type: Wall-Hung

\*Only Suitable for Mixer Tap

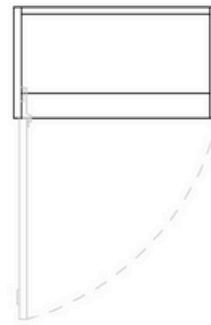
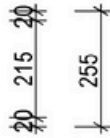
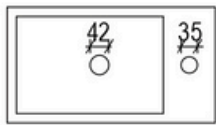
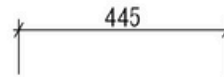
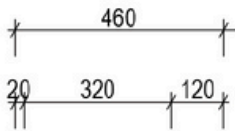
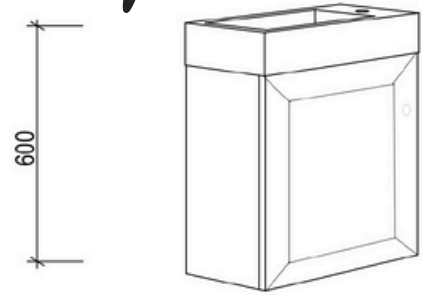

Top View

Section - Top

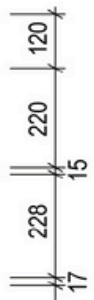
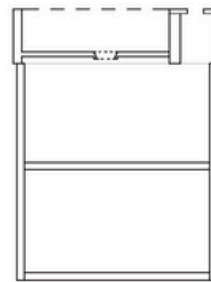
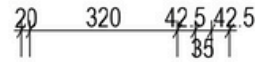
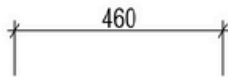

Front Elevation

Section

### Notes:

- Wastes and faucets are not included.
- Vanity unit must be installed by a qualified tradesmen - Failure to do so will void the warranty.
- Plumbing fixtures must be installed by a qualified plumber - Failure to do so will void the warranty.
- Warranty information: 5 years on cabinet & 12 months on top and basin(s).
- Caution boxes may be heavy and will require 2 people to lift.



[vanitybydesign.com.au](http://vanitybydesign.com.au)



[vanitybydesign\\_](https://www.instagram.com/vanitybydesign_)



TEL: 07 3376 6055



241 Monier Road  
Darra, QLD, 4076

V

# Customer Photos



@stevecordony

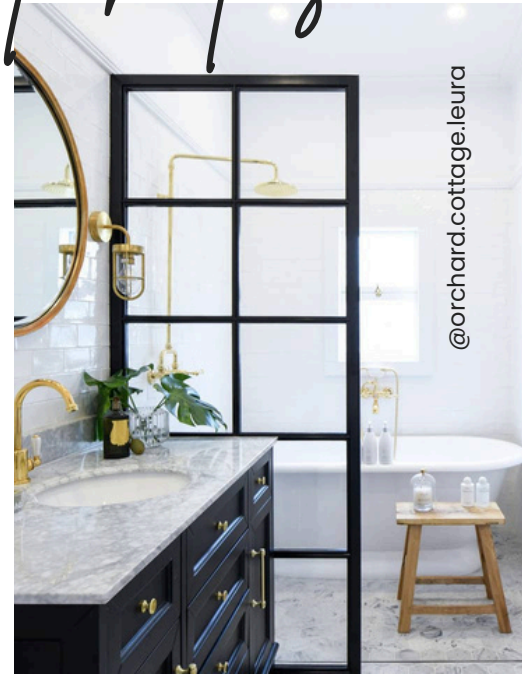

@orchard.cottage.leura



@eleanorpendleton



@homesbyhoven



@stevecordony



@stevecordony



[vanitybydesign.com.au](http://vanitybydesign.com.au)



[vanitybydesign\\_](https://www.instagram.com/vanitybydesign_)



TEL: 07 3376 6055



241 Monier Road  
Darra, QLD, 4076